

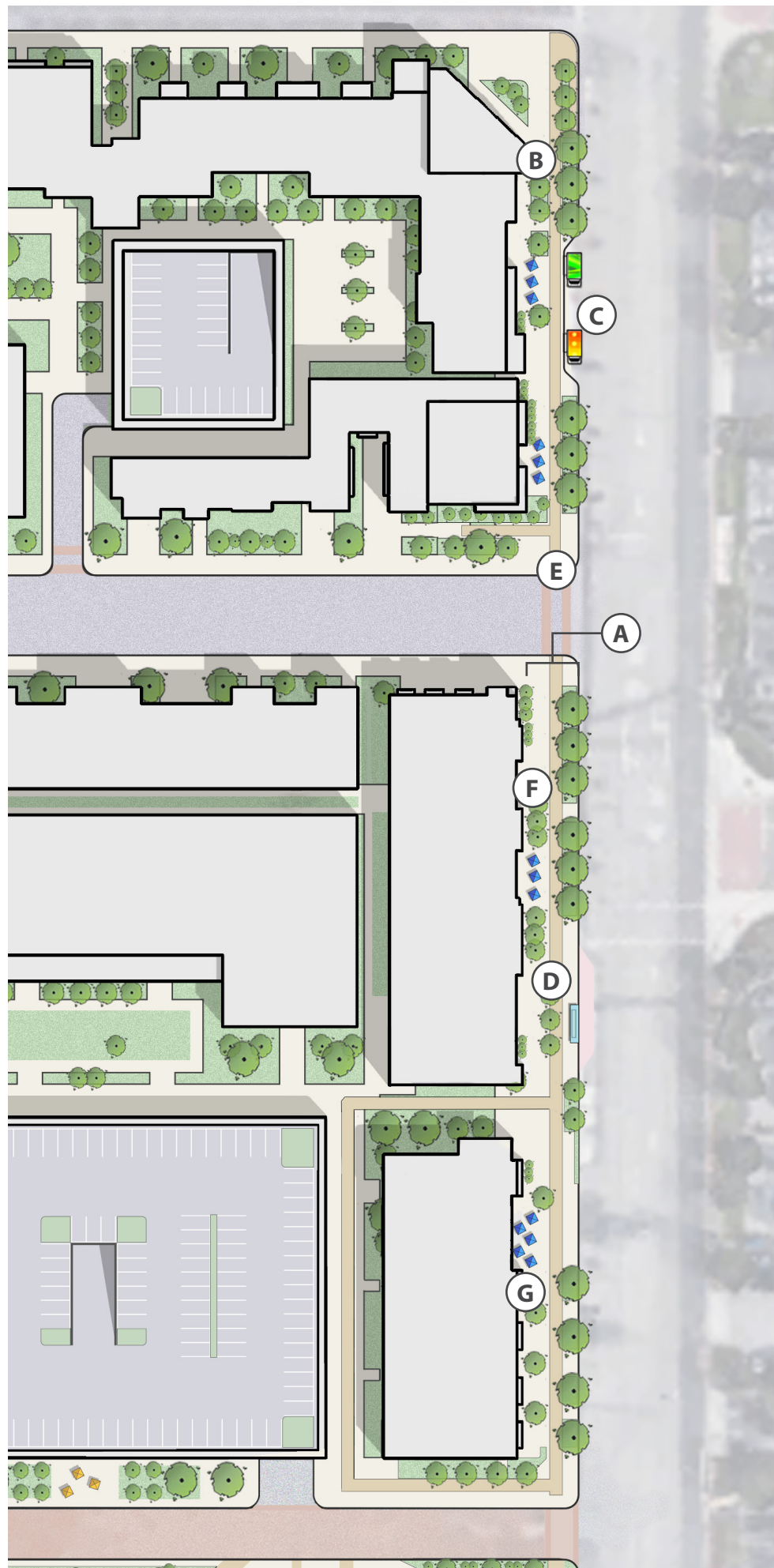

- ① Promenade on Highland
- ② Paseo on Primary Rail Frontage
- ③ Greenbelt Paseo
- ④ Adaptive Reuse Internal Interface
- ⑤ Pedestrian Access to Train



Promenade on Highland Avenue

- Ⓐ 25' pedestrian and streetscape zone along Highland
- Ⓑ Landscaping and streetscape amenities, including planting in tree grates, widened sidewalk and enhanced landscape/plaza space with decorative paving
- Ⓒ Turnout for food truck gathering and passenger loading zone
- Ⓓ Enhanced bus stop and passenger loading zone
- Ⓔ Material changes to demarcate walk paths and pedestrian crossings
- Ⓕ Shopfront entries on Highland Ave to activate the space
- Ⓖ Outdoor dining and street furniture to help create a distinct identity for the Promenade

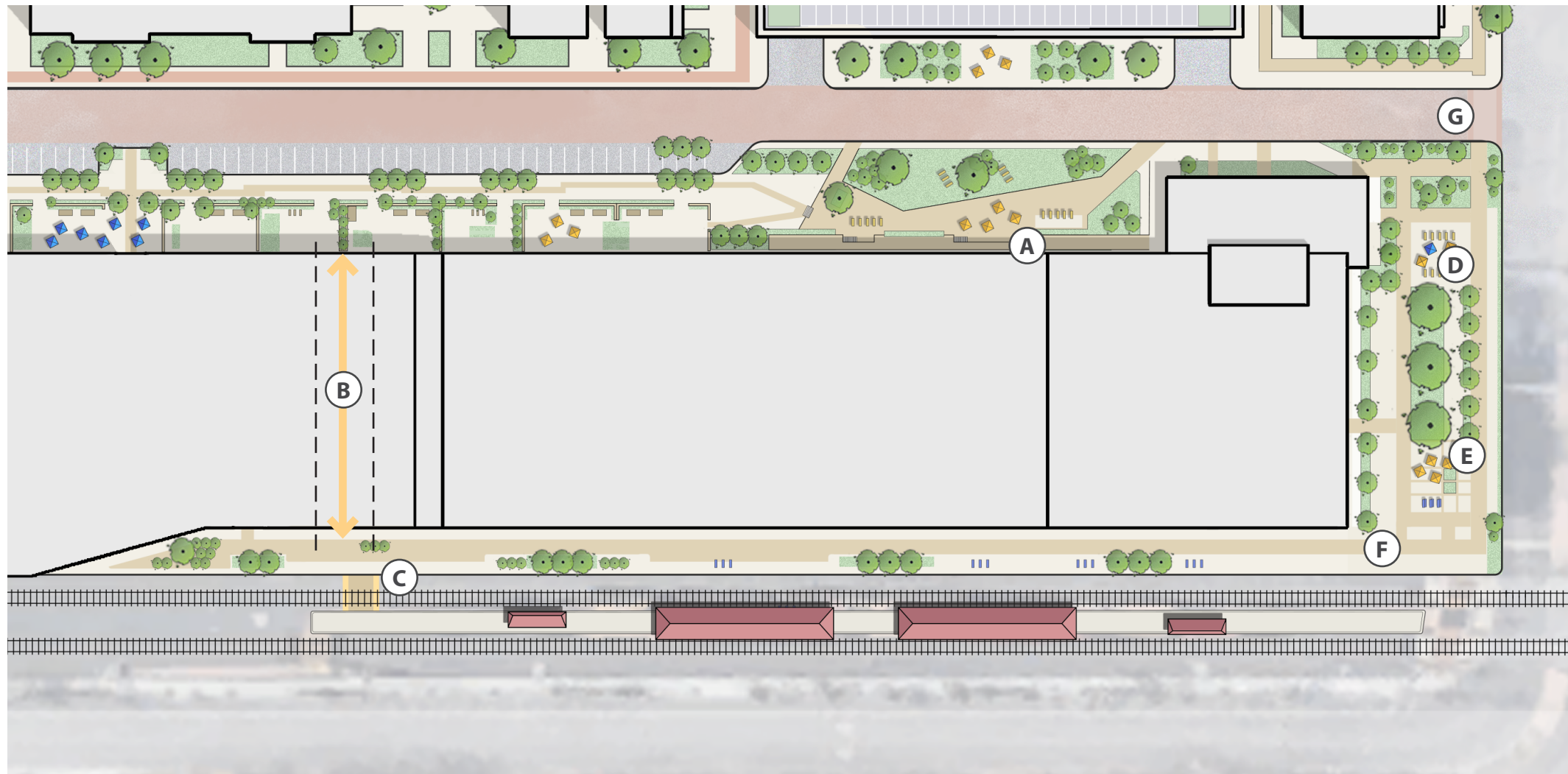

Paseo on Primary Rail Frontage and Highland Promenade

- A** Well-lit and landscaped paseo with pedestrian amenities
- B** Potential future pedestrian connection through frontage structure
- C** Direct and unobstructed public pedestrian connection to and from the west end of the station platform
- D** Public gathering space with ample seating, shade, and landscaping
- E** Decorative hardscaping and public art installation
- F** Clear and demarcated pedestrian connections to and from the rail station
- G** Highly-visible pedestrian crossings at driveways and streets

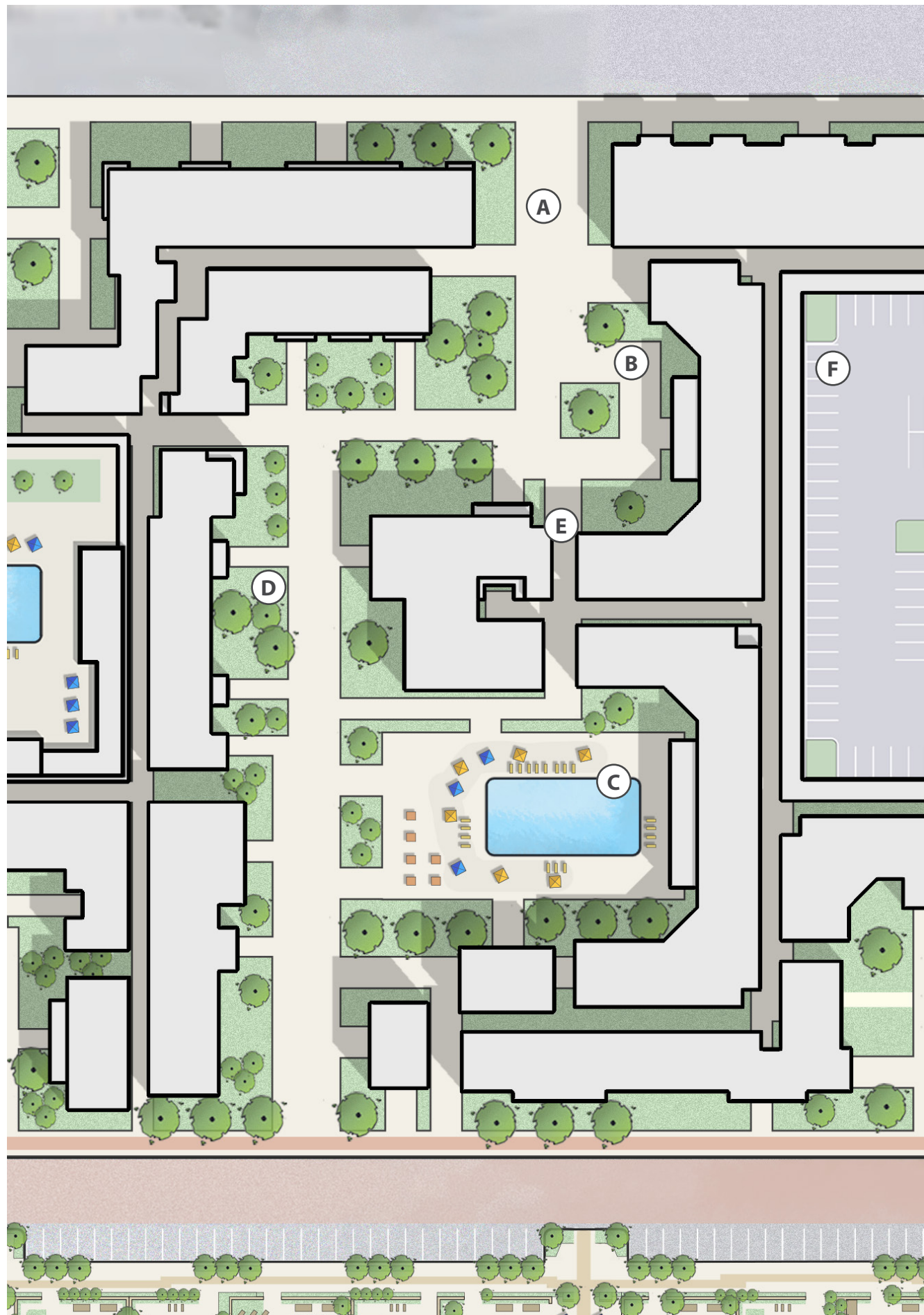

Greenbelt

- Ⓐ Quasi-public pedestrian paseo
- Ⓑ Mini-plazas and gathering spots with amenities located in areas along paseo
- Ⓒ Pool area with amenities for residents
- Ⓓ Enhanced landscaping
- Ⓔ Pedestrian pathways provide breaks between buildings
- Ⓕ Shared/consolidated parking, reducing vehicular/pedestrian conflict

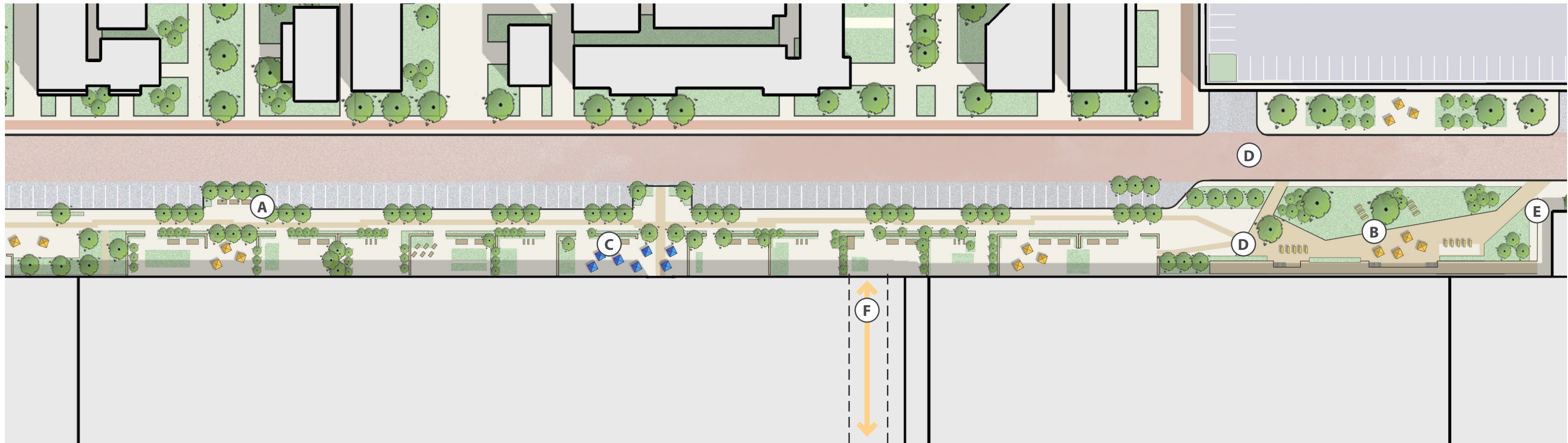

Adaptive Reuse Internal Interface

- A** Well-landscaped building entrance areas, buffered from driveway and parking
- B** Gathering space with attractive design, landscaping, hardscaping, and amenities such as outdoor seating, coworking spaces, and outdoor games
- C** Personalized frontages to individual businesses, which could include elevated decks or landscaping to support outdoor coworking space
- D** Material variation for walkpaths, access drives, and pedestrian crossings
- E** Pedestrian connections to Highland Promenade
- F** Pedestrian connections to Station platform (west) and rail frontage paseo

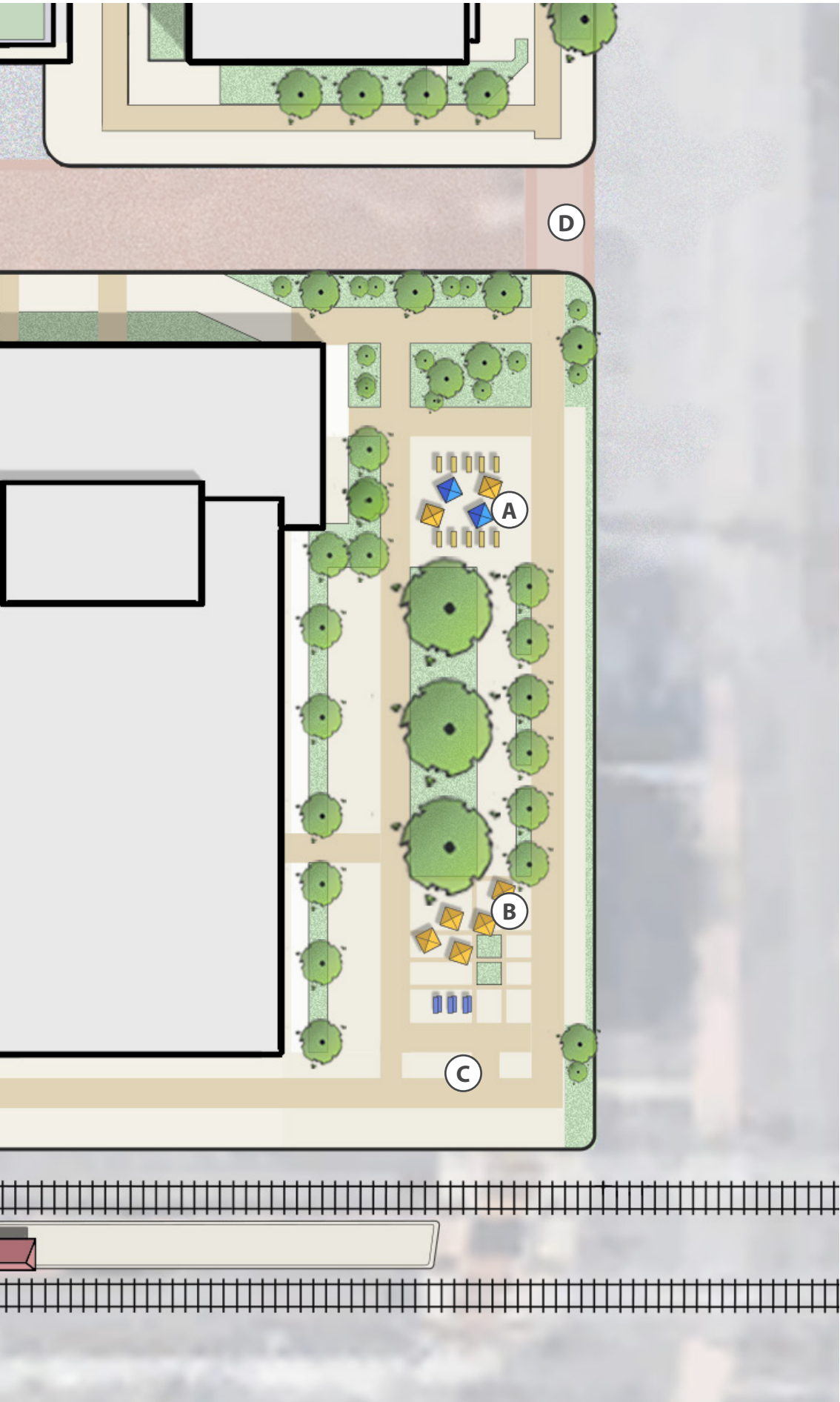

Rail Plaza

- Ⓐ Public gathering space with ample seating, shade, and landscaping
- Ⓑ Decorative hardscaping and public art installation
- Ⓒ Clear and demarcated pedestrian connections to and from the rail station
- Ⓓ Highly-visible pedestrian crossings